

## Stirling Building

Information Update from University of Cambridge and Construction Partners, SDC

Dear Sidgwick site users and neighbours of the Stirling Project,

Welcome to the April edition of the Stirling project newsletter. In this issue we share updates to the current progress, design and programme, key milestones will also be highlighted.

There has recently been a further discovery of materials containing asbestos which has increased the scope of works. We continue to remove this in a safe and controlled manner, and you have our continued reassurance that there is no risk of contamination for any staff or surrounding users of the site.

The recent weeks have seen an increase in activity on the site with works both to the existing building and new south pavilion structure. Inside the building, as well as asbestos removal, work has started to strengthen existing slabs. This work allows us to create new ducts to modernise the heating and other building services. The base for the tower crane is underway, with the deep piles being drilled ready for a concrete cap to encase them allowing the cranes ground anchor to be secured.

The tower crane will be erected over the weekend on 15 and 16 May. During this weekend, there will be a re-routing of the pedestrian walkway between The Faculties of English and Divinity and our site boundary. An increase in traffic marshal personnel and supervision will be managing pedestrian access routes, and deliveries from West Road during this weekend. As stated in the previous newsletter, the tower crane jib (beam that supports the load) will extend beyond the SDC site boundary, but the load hanging from the hook, never will. There is a GPS tracker built into the crane that physically does not let a load sail beyond the set parameters. The crane omits low levels of noise and reduces the need for other vehicles and machines moving around at ground level, reducing the overall noise levels from the site. As ever, if you have any queries regarding this or other pieces of equipment, please

### Contact Us

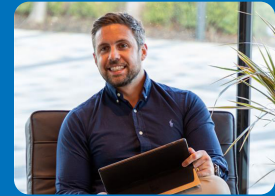

**Tom Fenner**  
Project Director

@ Tom.Fenner@sdc.co.uk

📞 07831 165880



**Tom Kindred**  
Construction Manager

@ Tom.Kindred@sdc.co.uk

📞 07825 363418

🖱️ [sdc.co.uk](http://sdc.co.uk)

🌐 @SDC Builders Ltd

📷 @sdcbuildersltd

do get in touch.

Design work has also progressed. The team visited the Netherlands to look at a sample of the new façade. Coordination workshops focussing on the relationship between the structure and façade have been a key focus this month. The development of building services has continued with thermal comfort and high air quality remaining the key goals of this process.

We have entertained various visits from surrounding Departments and stakeholders in recent times, and it remains our privilege to show interested parties around. If you have any desire to further understand the project, please do arrange a visit.

We thank you for your ongoing patience whilst we are working on the Sidgwick Site, and we welcome any feedback by email to [Stirling.Project@admin.cam.ac.uk](mailto:Stirling.Project@admin.cam.ac.uk)

With kind regards,

**Tom Kindred**  
Construction Manager  
SDC Builders Ltd

## Progress at a Glance

- Continuation of asbestos removals
- Concrete slab strengthening
- North pavilion new build foundations and drainage
- Tower crane base and erection
- Removal of external reading room glazing, subject to approval

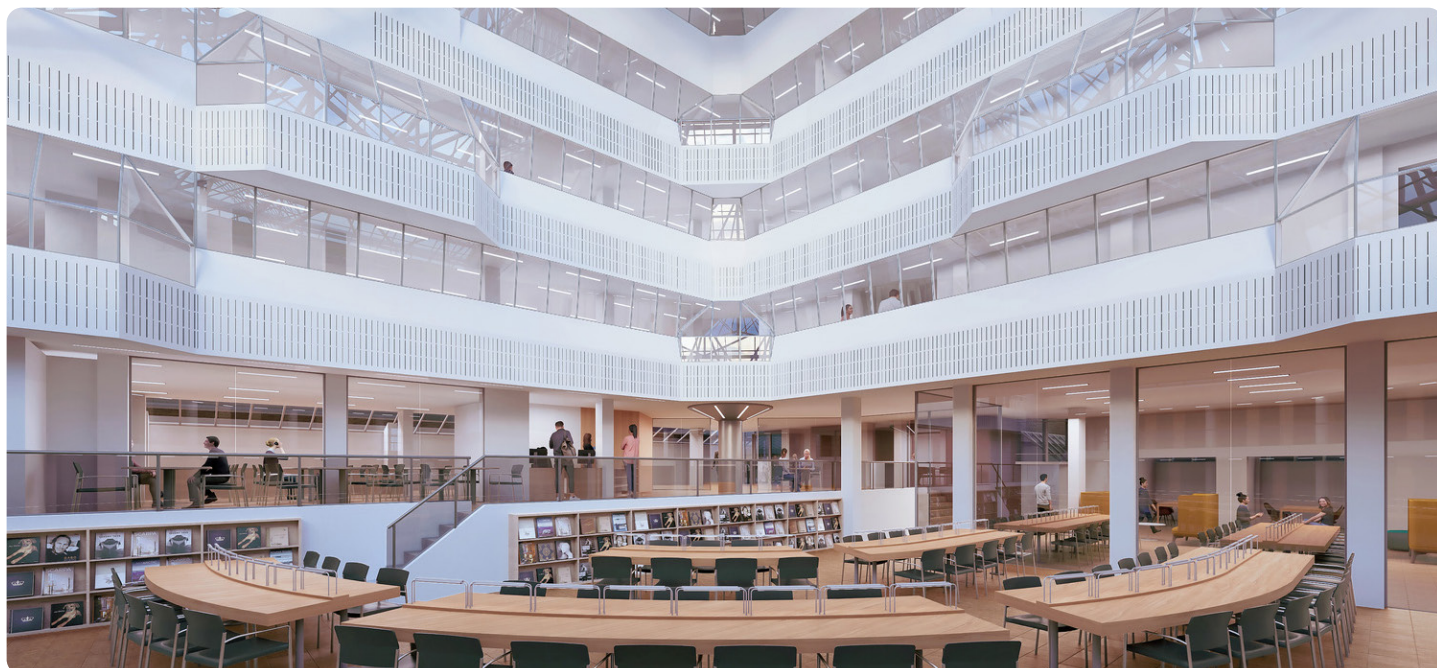

Internal render of Seeley Library