

Stirling Building

Information Update from University of Cambridge and Construction Partners, SDC

Dear Sidgwick site users and neighbours of the Stirling Project.

Welcome to the June edition of the Stirling Project Newsletter. In this edition, we provide an update on the works that have started now that the project is in the main contract phase, as well as changes to site logistics following the installation of the tower crane.

Since our last update, additional asbestos-containing materials have been identified, increasing the scope of the removal works. We continue to remove these materials in a safe and controlled manner and would like to reiterate that there is no risk of contamination to site users or neighbouring occupants.

The tower crane installation, carried out over the weekend of 17–18 May, was completed successfully. Site perimeters and pedestrian walkways were reinstated promptly, allowing normal operations to resume on Monday morning. We would like to thank everyone for their cooperation during this period and hope that any disruption was kept to a minimum. A special thanks goes to the users and management teams of the Divinity and Music buildings, who were most affected by these works.

The tower crane has now undergone all required safety inspections and commissioning procedures. Its GPS zoning system has been configured to ensure that no live loads can be lifted beyond the site boundary. Should you have any questions or concerns regarding the crane operation, please do not hesitate to contact the project team.

The project formally entered the main contract phase on 18 May following agreement of the full contract and approval of amendments to the planning consent. As a result, several major work packages have now commenced. One of the first significant activities has been the removal of the external façade. As many of you will have noticed, the original glazing system to the Reading Room roof has now largely been removed, along with the internal

Contact Us



Tom Fenner
Project Director

@ Tom.Fenner@sdc.co.uk

📞 07831 165880



Tom Kindred
Construction Manager

@ Tom.Kindred@sdc.co.uk

📞 07825 363418

🖱️ sdc.co.uk

@SDC Builders Ltd

@sdcbuildersltd

access walkways within the roof structure.

Internally, the removal of the remaining known asbestos materials on the ground floor is progressing well. Structural enhancement works have also been completed to strengthen the concrete slabs at the end of L Block, enabling openings for service pipes and ducts to be formed. These will support upcoming mechanical and electrical first-fix installations and will allow the building services to be distributed more efficiently throughout the refurbished building.

Meanwhile, the design teams continue to develop and finalise internal floor layouts to support the next stages of construction. The design of the new external façade is also progressing well, with several components now completed and entering manufacture ahead of installation, which is scheduled to begin in the final quarter of this year.

We also marked National Volunteers' Week (1-7 June) - an initiative which SDC is proud to support. Members of the project team have been supporting a number of activities across the site. This includes refurbishing the benches outside the Arc Café, cleaning and restoring them before returning them to use. We also have a team working within the Old House at Music, redecorating the Board Room and the Custodian's Office. Please do get in touch if there is anything that the team can help you with.

We would like to thank you for your continued patience and support as work progresses on the Stirling Project. As always, we welcome your feedback, which can be directed to the project email address, Stirling.Project@admin.cam.ac.uk

With kind regards,

Tom Kindred
Construction Manager
SDC Builders Ltd

Progress at a Glance

- Continue removal of Reading Room Roof Glazing
- Commence removal of roof steel structure
- Continue asbestos removal
- Continue preparation works for mechanical & electrical installation

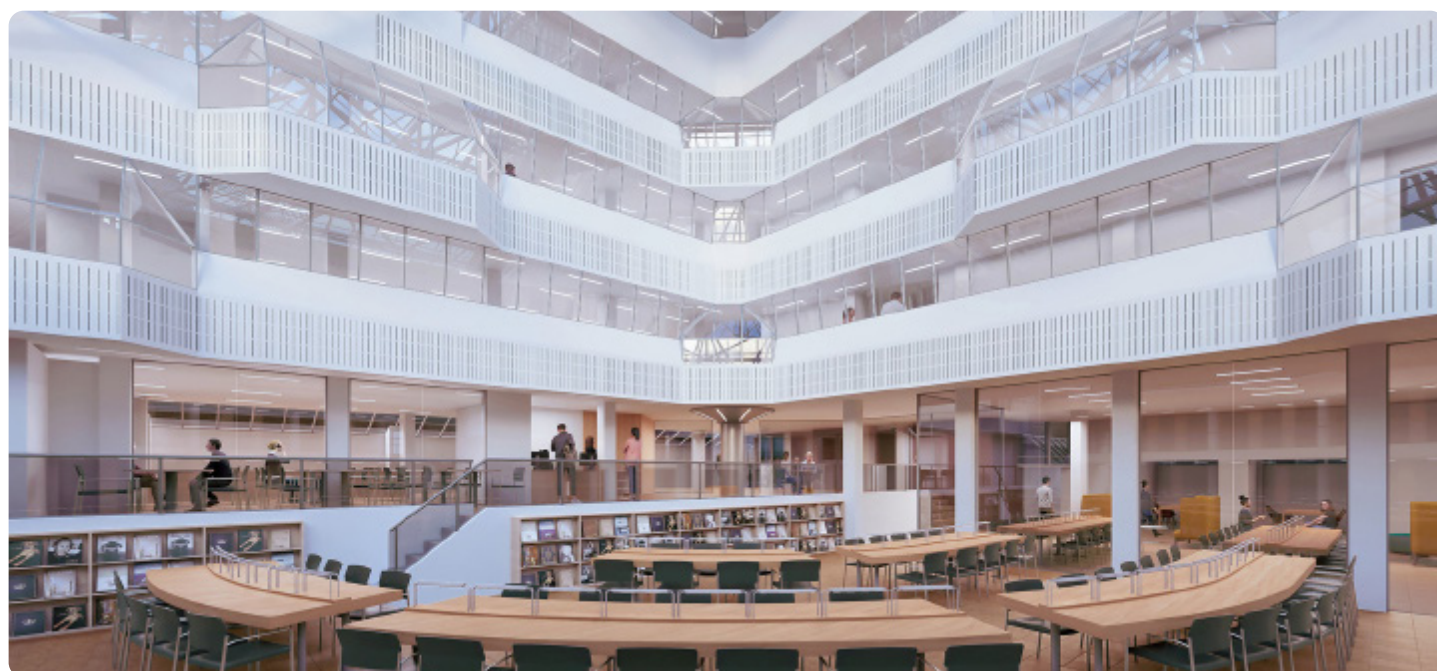

Internal render of Seeley Library